

REFERENCES

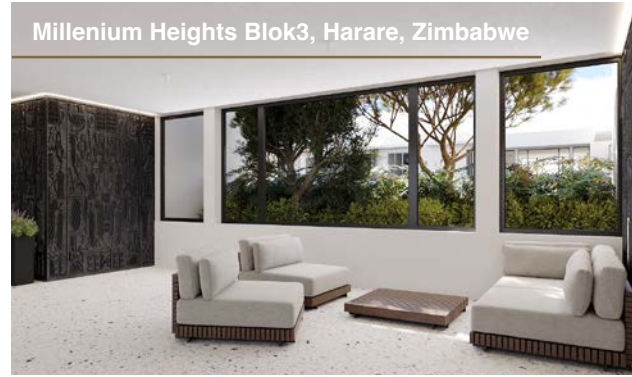

Millenium Heights Blok3, Harare, Zimbabwe



Millenium Heights Blok3, Harare, Zimbabwe



SMK Tower Ankara



İş GYO İstanbul



Danıştay Ankara

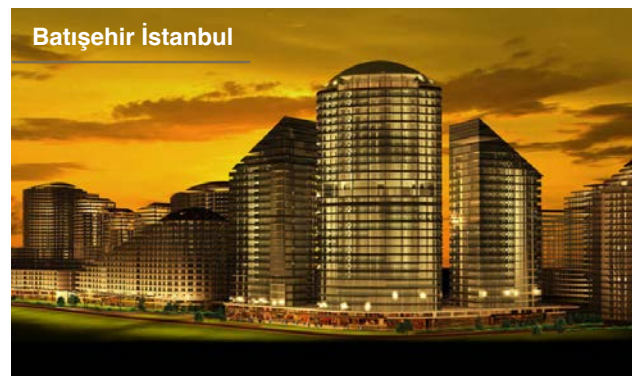

Batışehir İstanbul



Burç İstanbul



Istanbul Office
Burak Plaza
İstoç Oto Ticaret Merkezi
2. Cadde A2 Blok
No:1 Kat:13
Bağcılar / İstanbul / Türkiye

Factory
Yeni Mahalle 15. Sokak No:3
Lüleburgaz / Kırklareli / Türkiye
Phone: +90 444 37 40
Phone: +90 (288) 436 12 34
Fax: +90 (288) 436 13 63
Email: info@burak.com.tr

Scan Code for Catalogue



@burakaluminum

/burak.aluminyum

/burakaluminum

www.burak.com.tr

ARCHITECTURAL SYSTEMS



ES45

Uninsulated
Economical System

• System Brochure
• Technical Properties
• System Details
• References



History

It founded its first extrusion line in 1991 to produce aluminium profiles. In 1995, electrostatic powder coating unit and foundry was opened. Burak implemented its first export in 1996. And the second extrusion line was commissioned in 1997. Extrusion lines were revised, and the foundry's capacity was increased in 1998. Developing of architectural aluminium building systems was commenced in 2002. 1,400 and 2,000 tons of extrusion lines, anodization unit CNC mechanical processing machinery were commissioned, and the 1st phase construction of 12,500 sqm Luleburgaz plant was completed between 2003 and 2008. The foundation of Luleburgaz plant was completed in 2011. Aksan Aluminium; that is the first extrusion company joined the group in 2012. In 2013, total 85,000 sqm Luleburgaz plant with 65,000 sqm indoor space was completed and set into operation with 6 extrusion lines.

Product

Burak Alüminyum Industrial:
Burak Alüminyum also performs special alloy aluminium profile manufacture besides standard alloy extrusion profile. Besides serving industries such as automotive, aviation industry, heating-cooling, furniture promotions and rail systems which need qualified design from A to Z, it manufactures solar energy, semi-finished and finished products composed of aluminium such as caravan, automotive, industrial fridges, and radiators.

Burak Alüminyum Architectural Systems:
Burak develops architectural solutions. Manufacturing facade, doors and windows, sliding, office partition systems, handrail profiles and their compatible accessories, Burak also manufactures aluminium composite panels via its **BURAKBOND®** and **alu-linebond®** brands and exports these products more than 70 countries.



PRODUCT CONCEPT



ES45 is an uninsulated door system designed for inward and outward opening doors, crafted to the highest European quality standards. This simple yet highly innovative design offers a cost-effective solution to its optimized fabrication process.

PERFORMANCE
Hinged systems are preferred particularly in houses. Performance of hinged systems that covered as a shield and keeping from forced conditions of out environment is more important than the other systems. With development of technology, minimum enough comfort requirements of houses rise day by day and design offices have to develop economical and high performance products. ES45 has even high impermeability values of air-water-wind, and too it has high acoustic performance. So through these facilities of ES45, it performs fact thoroughly that "maximum comfort at living area".

ENERGY SAVING
Subjects of environment sensitivity and energy saving become important day by day. For this reason thermal insulation specifications was become on high level in ES45. Even though Aluminium is cold material, it can be transformed reasonably insulator with developing material variability, design methods and new technologies. ES45 is designed by focused performance according to actual requirements.

EASE OF MANUFACTURING
Accessories of ES45 was designed as logic of collective and harmonious with each other. So ES45 has unique construction by ease of manufacturing.

IMPROVABILITY
ES45 was designed as smoothly developable system concept. In this way adaptation of new system solutions can be done quickly.

UNINSULATED HINGED SYSTEM

TECHNICAL PROPERTIES

| | |
|--------------------------------|-------------------------|
| Frame Depths: | 45 mm |
| Sash Depths: | 47,6 mm / 54,5 mm |
| Profile Wall Thickness: | 1,3 mm - 1,6 mm |
| Max. Glass Thickness: | 24 mm |
| Insulation Bars: | 14,8 mm |
| Thermal Insulation Value (Uf): | 2,77 W/m²K - 3,65 W/m²K |

APPLICATION ALTERNATIVES

| | Window | Door |
|------------------------|--------|------|
| Inward Opening Step: | • | • |
| Outside Opening Step: | | |
| Inward Opening Flush: | | |
| Outside Opening Flush: | | |
| Hidden Vent: | | |
| Tilt & Turn: | • | • |
| Tilt & Slide: | | |
| Folding: | | |

ES45 SYSTEM DETAILS

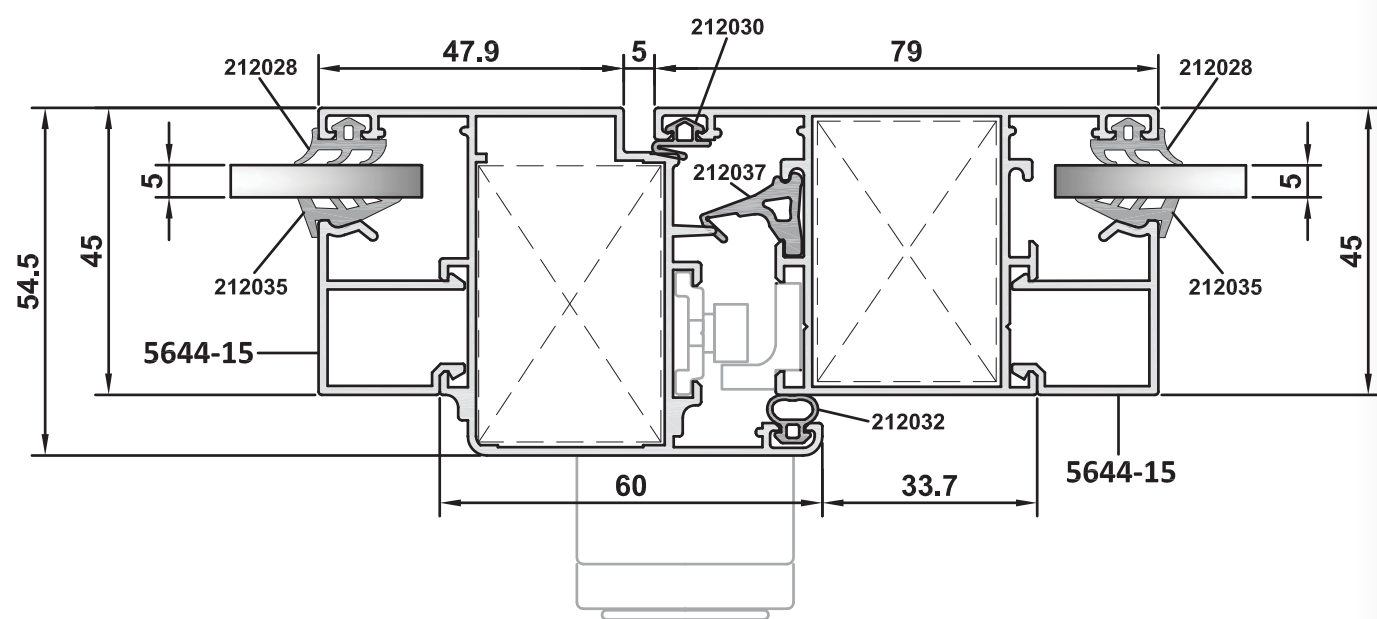
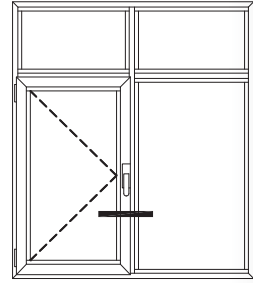
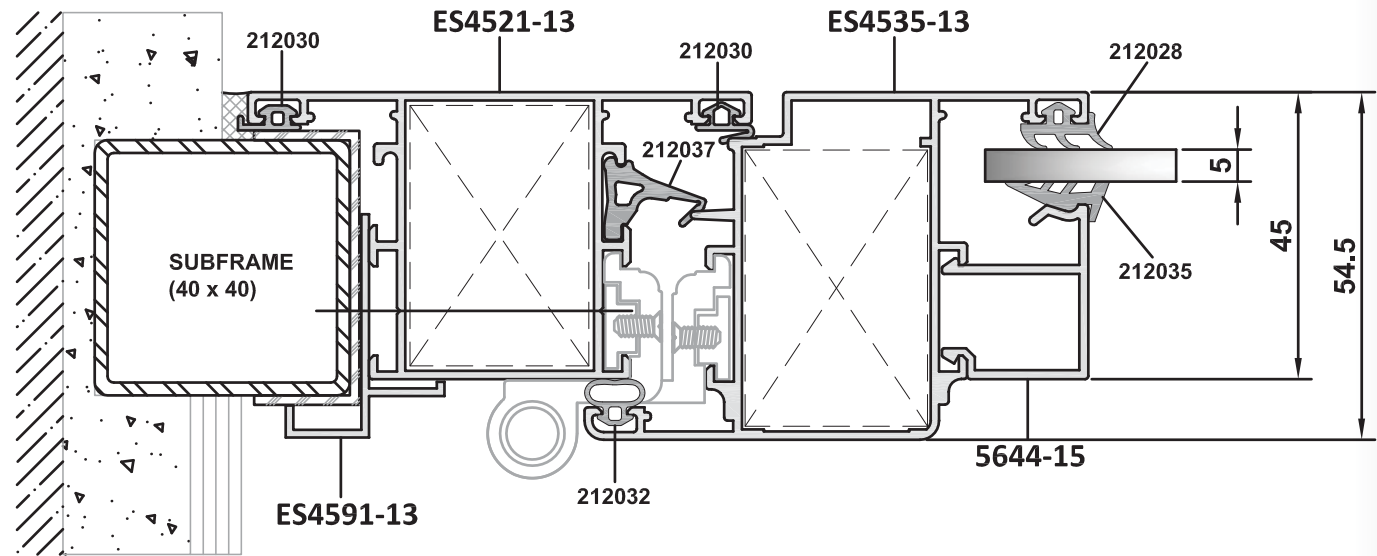
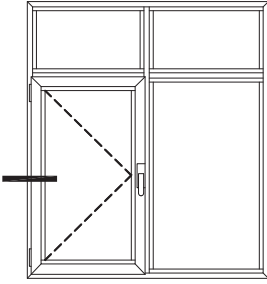

ES45 SYSTEM DETAILS

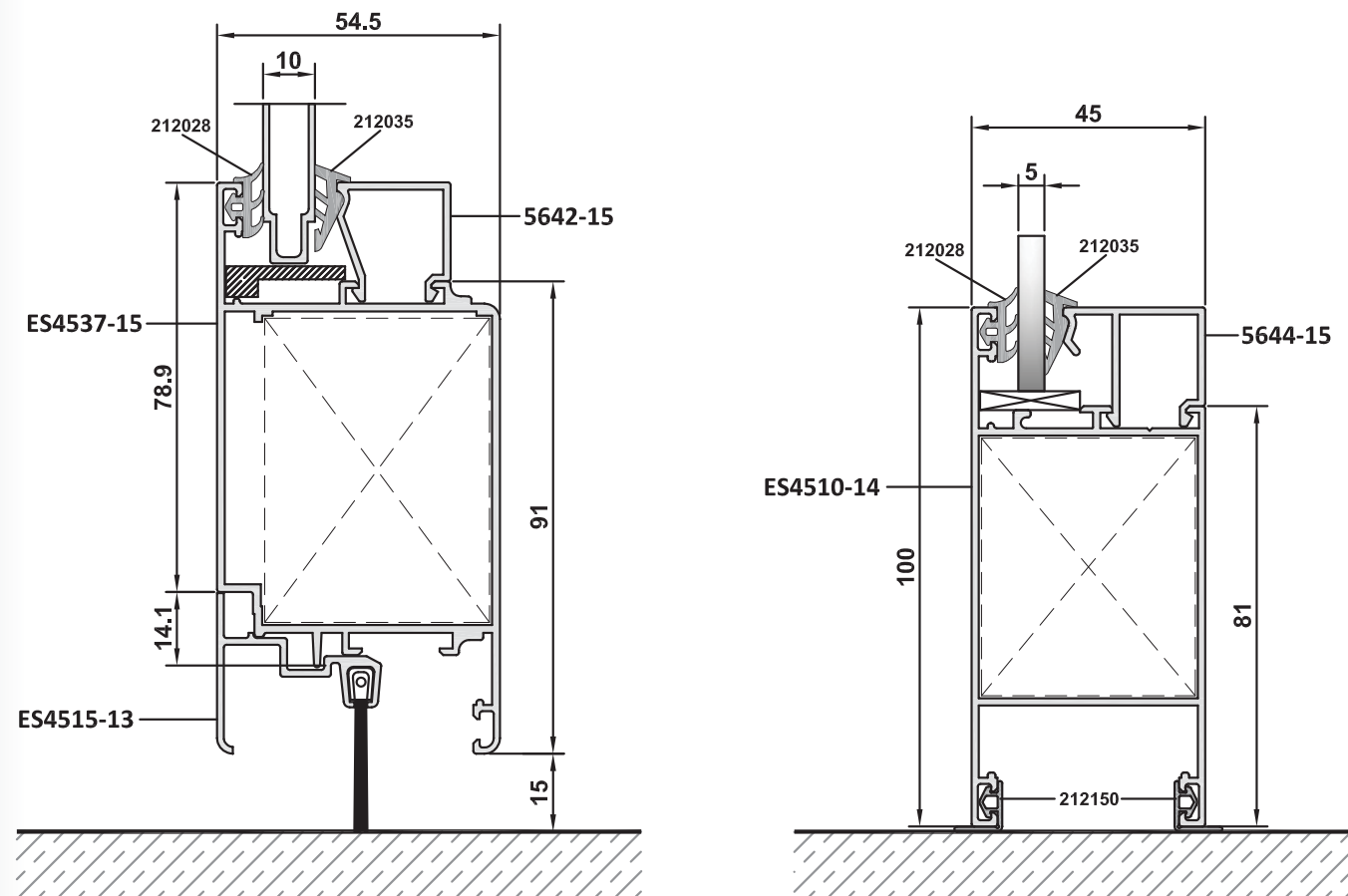
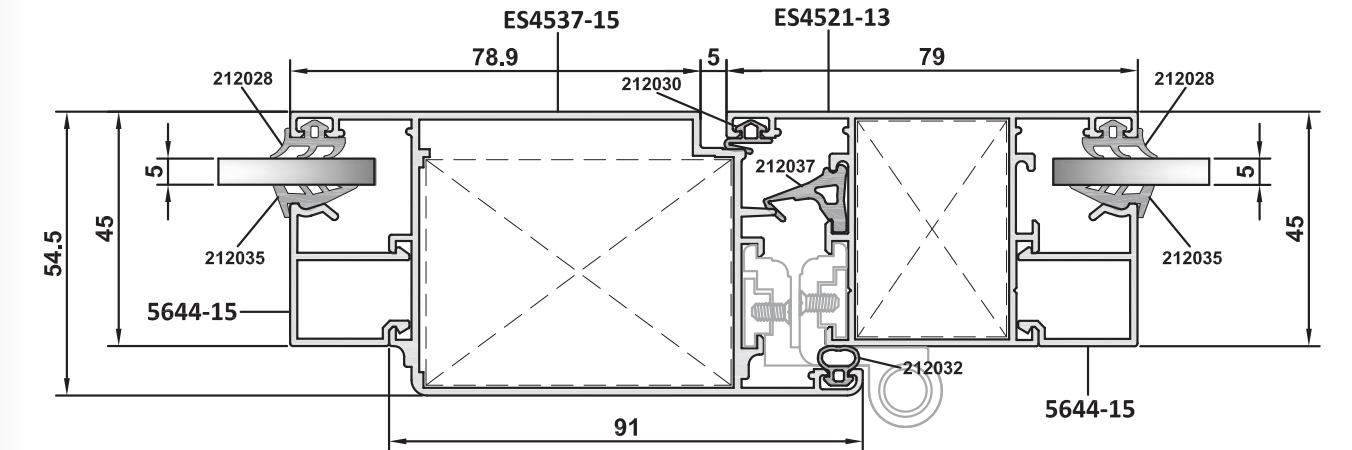
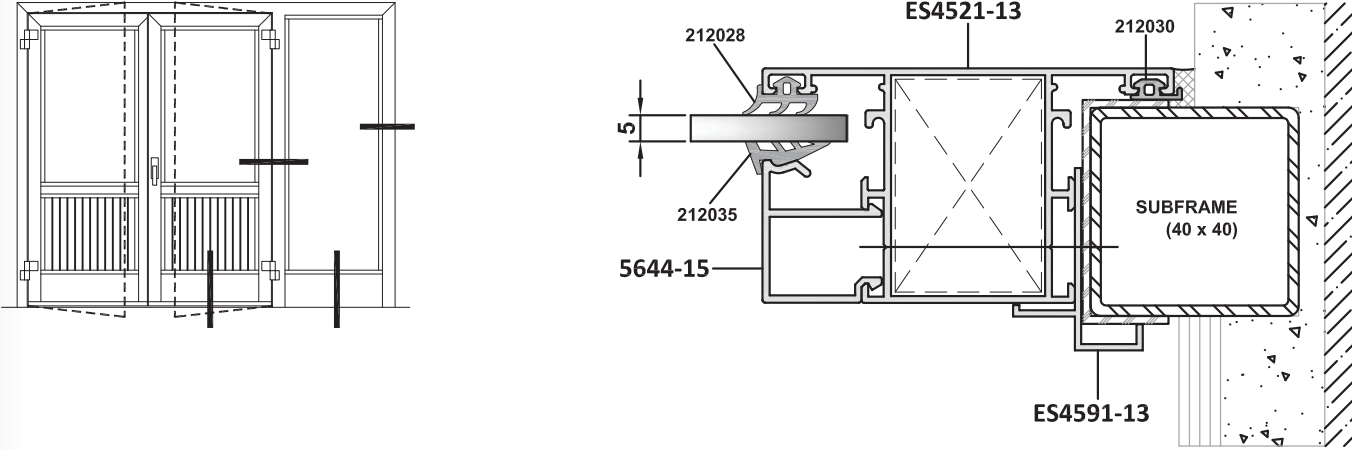
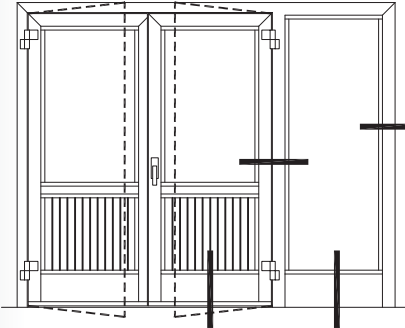

ES45 SYSTEM DETAILS

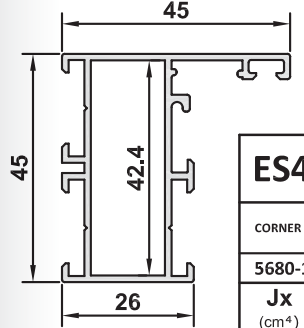

| ES4501-13 | | | |
|------------------------------|----------|---|---|
| CORNER CLEATS AND ALIGNMENTS | | | |
| 5680-14 (42mm) | | | |
| Jx (cm²) | Jy (cm²) | Y | X |
| 7,41 | 2,93 | | |
| WEIGHT | | | |
| 0,707 kg/m | | | |

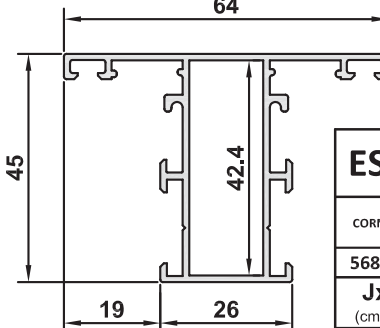

| ES4520-13 | | | |
|------------------------------|----------|---|---|
| CORNER CLEATS AND ALIGNMENTS | | | |
| 5680-14 (42mm) | | | |
| Jx (cm²) | Jy (cm²) | Y | X |
| 7,75 | 6,17 | | |
| WEIGHT | | | |
| 0,813 kg/m | | | |

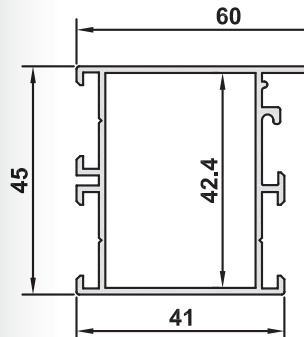

| ES4502-13 | | | |
|------------------------------|----------|---|---|
| CORNER CLEATS AND ALIGNMENTS | | | |
| 5680-29 (42mm) | | | |
| Jx (cm²) | Jy (cm²) | Y | X |
| 11,06 | 6,64 | | |
| WEIGHT | | | |
| 0,813 kg/m | | | |

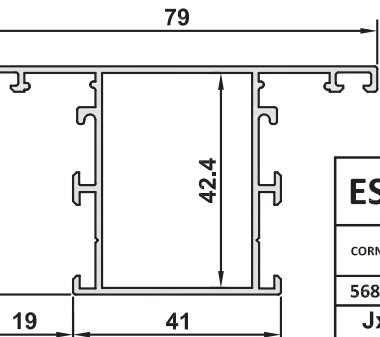

| ES4521-13 | | | |
|------------------------------|----------|---|---|
| CORNER CLEATS AND ALIGNMENTS | | | |
| 5680-29 (42mm) | | | |
| Jx (cm²) | Jy (cm²) | Y | X |
| 13,43 | 9,78 | | |
| WEIGHT | | | |
| 0,916 kg/m | | | |

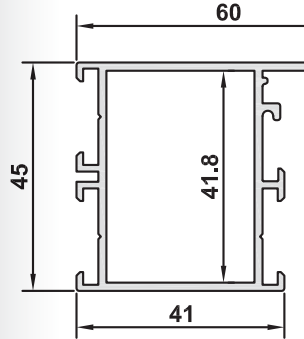

| ES4502-16 | | | |
|------------------------------|----------|---|---|
| CORNER CLEATS AND ALIGNMENTS | | | |
| 5680-29 (41mm) | | | |
| Jx (cm²) | Jy (cm²) | Y | X |
| 11,06 | 6,64 | | |
| WEIGHT | | | |
| 0,940 kg/m | | | |

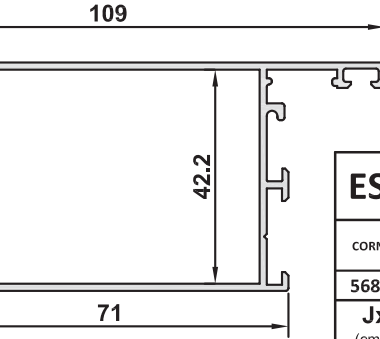

| ES4524-14 | | | |
|------------------------------|----------|---|---|
| CORNER CLEATS AND ALIGNMENTS | | | |
| 5680-59 (41,5mm) | | | |
| Jx (cm²) | Jy (cm²) | Y | X |
| 14,39 | 41,25 | | |
| WEIGHT | | | |
| 1,193 kg/m | | | |

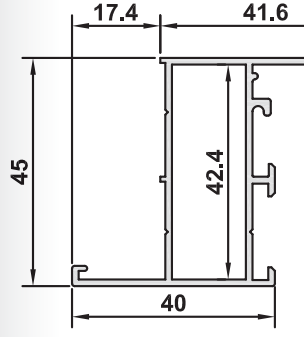

| ES4508-13 | | | |
|------------------------------|----------|---|---|
| CORNER CLEATS AND ALIGNMENTS | | | |
| 5680-14 (42mm) | | | |
| Jx (cm²) | Jy (cm²) | Y | X |
| 11,06 | 6,64 | | |
| WEIGHT | | | |
| 0,700 kg/m | | | |

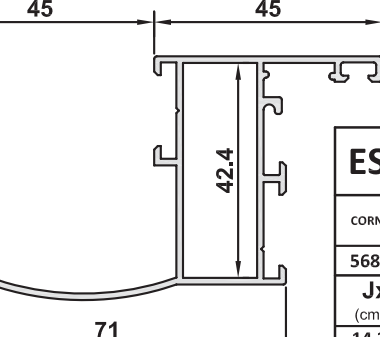

| ES4509-13 | | | |
|------------------------------|----------|---|---|
| CORNER CLEATS AND ALIGNMENTS | | | |
| 5680-14 (42mm) | | | |
| Jx (cm²) | Jy (cm²) | Y | X |
| 14,39 | 41,25 | | |
| WEIGHT | | | |
| 0,872 kg/m | | | |