

REFERENCES



Istanbul Office
Burak Plaza
İstoç Oto Ticaret Merkezi
2. Cadde A2 Blok
No:1 Kat:13
Bağcılar / İstanbul / Türkiye

Factory
Yeni Mahalle 15. Sokak No:3
Lüleburgaz / Kırklareli / Türkiye
Phone: +90 444 37 40
Phone: +90 (288) 436 12 34
Fax: +90 (288) 436 13 63
Email: info@burak.com.tr

Scan Code for Catalogue



Instagram: @burakaluminum Facebook: /burak.aluminum Twitter: /burakaluminum

www.burak.com.tr

ARCHITECTURAL SYSTEMS



BG60

High Insulated
Curtain Wall System

• System Brochure
Technical Properties
System Details
References



History

It founded its first extrusion line in 1991 to produce aluminium profiles. In 1995, electrostatic powder coating unit and foundry was opened. Burak implemented its first export in 1996. And the second extrusion line was commissioned in 1997. Extrusion lines were revised, and the foundry's capacity was increased in 1998. Developing of architectural aluminium building systems was commenced in 2002. 1,400 and 2,000 tons of extrusion lines, anodization unit CNC mechanical processing machinery were commissioned, and the 1st phase construction of 12,500 sqm Luleburgaz plant was completed between 2003 and 2008. The foundation of Luleburgaz plant was completed in 2011. Aksan Aluminium; that is the first extrusion company joined the group in 2012. In 2013, total 85,000 sqm Luleburgaz plant with 65,000 sqm indoor space was completed and set into operation with 6 extrusion lines.

Product

Burak Alüminyum Industrial:
Burak Alüminyum also performs special alloy aluminium profile manufacture besides standard alloy extrusion profile. Besides serving industries such as automotive, aviation industry, heating-cooling, furniture promotions and rail systems which need qualified design from A to Z, it manufactures solar energy, semi-finished and finished products composed of aluminium such as caravan, automotive, industrial fridges, and radiators.

Burak Alüminyum Architectural Systems:
Burak develops architectural solutions. Manufacturing facade, doors and windows, sliding, office partition systems, handrail profiles and their compatible accessories, Burak also manufactures aluminium composite panels via its **BURAKBOND®** and **alu-linebond®** brands and exports these products more than 70 countries.



PRODUCT CONCEPT

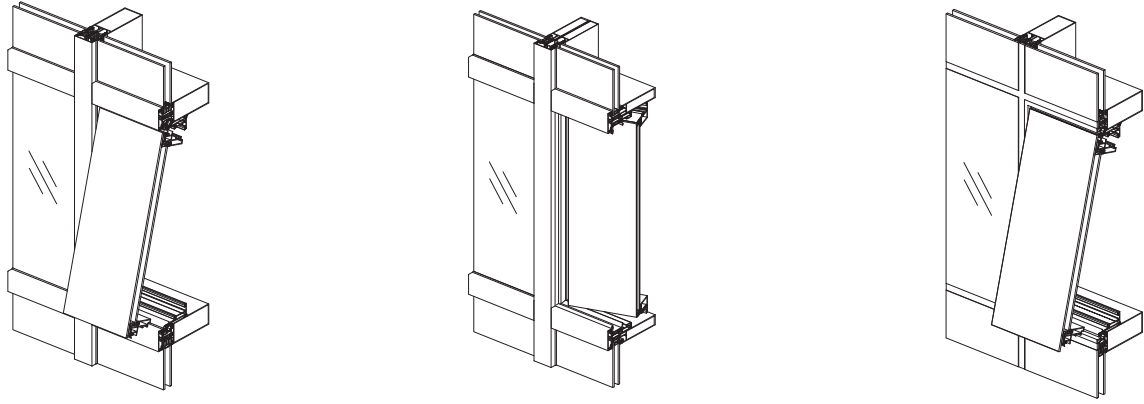

BG 60 "Burak Gıydirme 60mm" is new generation curtain wall system that combines capped curtain wall, two sided, four sided and structural cells in a single system.

ENERGY SAVING

Subjects of environment sensitivity and energy saving become important day by day. For this reason thermal insulation specifications was become on high level.

In spite of Aluminium is a cold material in accordance with its structure, it can be as insulative composite structure by variability of materials, design methods and technologies. BG 60 was designed exactly performance-focused as requirements of present day. Important sides of BG 50 are high performances of thermal and air-water tightness, variously usage options, easy manufacturing specifications.

INNOVATIVE DESIGN

Structure is look like conventional with vertical corner and thick lines in design. Conversely the corners with huge radius preferred with thin profile sections, curly surface and pitched edges. But ease of use and manufacturing specifications did not abandoned.

EASE OF MANUFACTURING

Accessories of BG 60 was mostly standardized. These accessories used generally common with each other. By this method, different types of products is manufactured with the same accessories.

IMPROVABILITY

BG 60 has the developable system concept as general. In this way adaptation of new system solutions can be done quickly.

HIGH THERMAL INSULATED CURTAIN WALL SYSTEM

TECHNICAL PROPERTIES

Profile Widths:	60 mm
Mullion Depths:	50, 70, 100, 120...200, 220, 230, 235, 250
Transom Depths:	55, 75, 95, 105, 125...205, 225, 235, 240, 255
Profile Wall Thickness:	2 - 4 mm
Max. Glass Thickness:	444 mm
Insulation Bars:	10 - 30 mm
Thermal Insulation Value (Uf):	1,39 W/m²K - 2,10 W/m²K

APPLICATION ALTERNATIVES

Capped Curtain Wall:	•
Curtain Wall With Structural Cells:	•
Four Sided Silicone Curtain Wall:	•
Two Sided Curtain Wall:	•
Top Hung Outward Opening Hidden Vent:	•
Parallel Outward Opening Hidden Vent:	•

BG60



CURTAIN WALL HORIZONTAL DETAIL

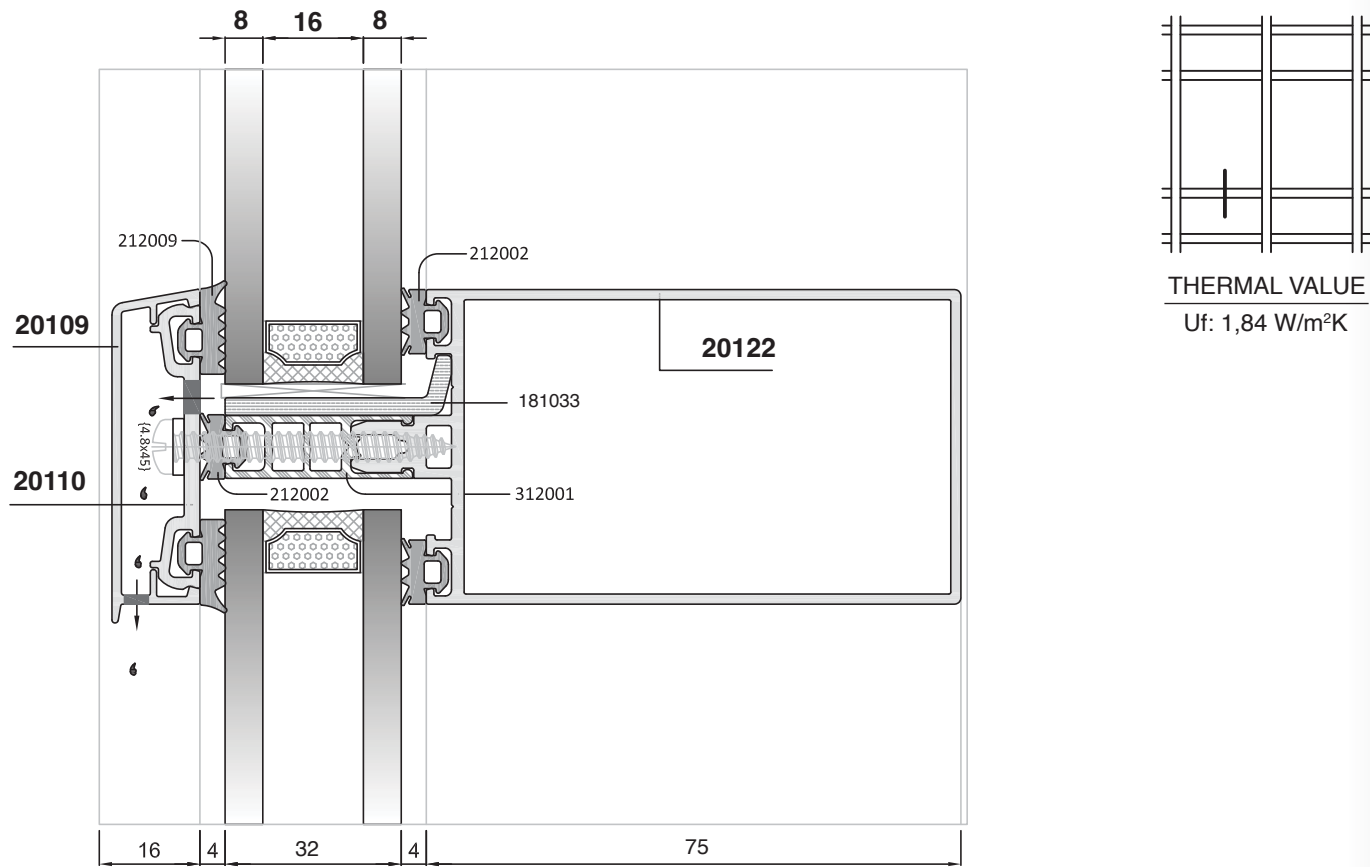

TOP HUNG OUTWARD OPENING DETAIL IN THE CURTAIN WALL

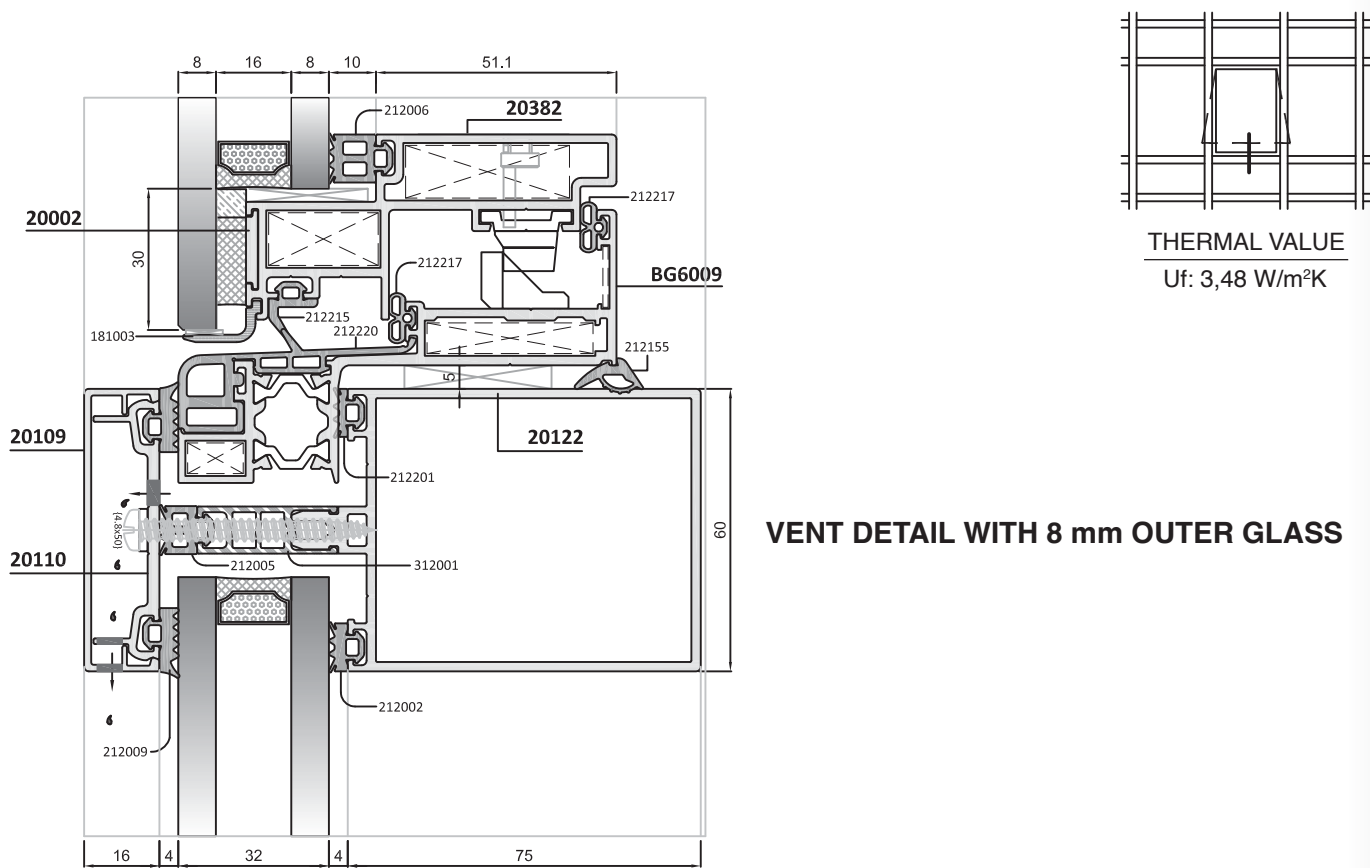

VENT DETAIL WITH 8 mm OUTER GLASS

FOUR SIDE HORIZONTAL DETAIL

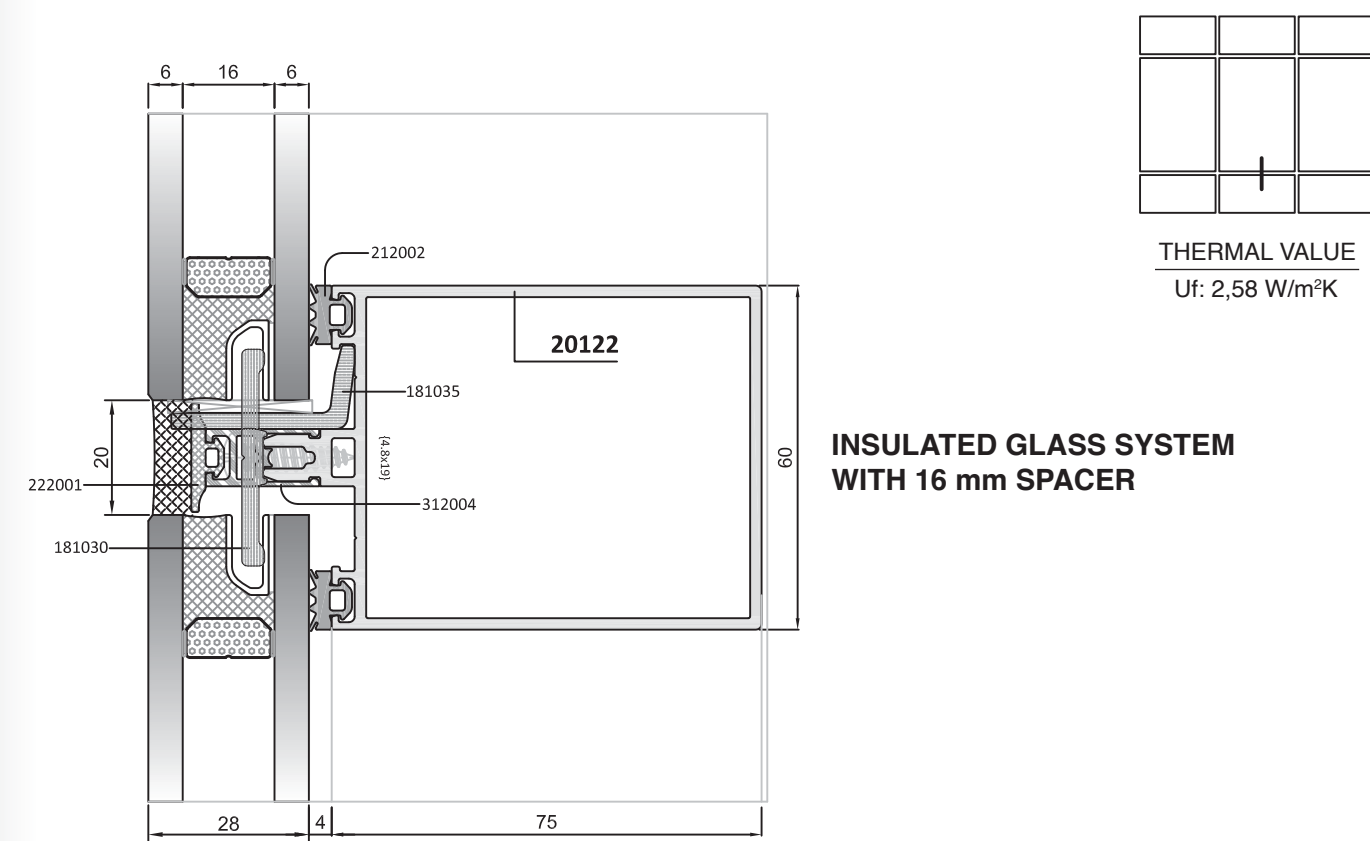

INSULATED GLASS SYSTEM
WITH 16 mm SPACER

TOP HUNG OUTWARD OPENING DETAIL IN FOUR SIDE

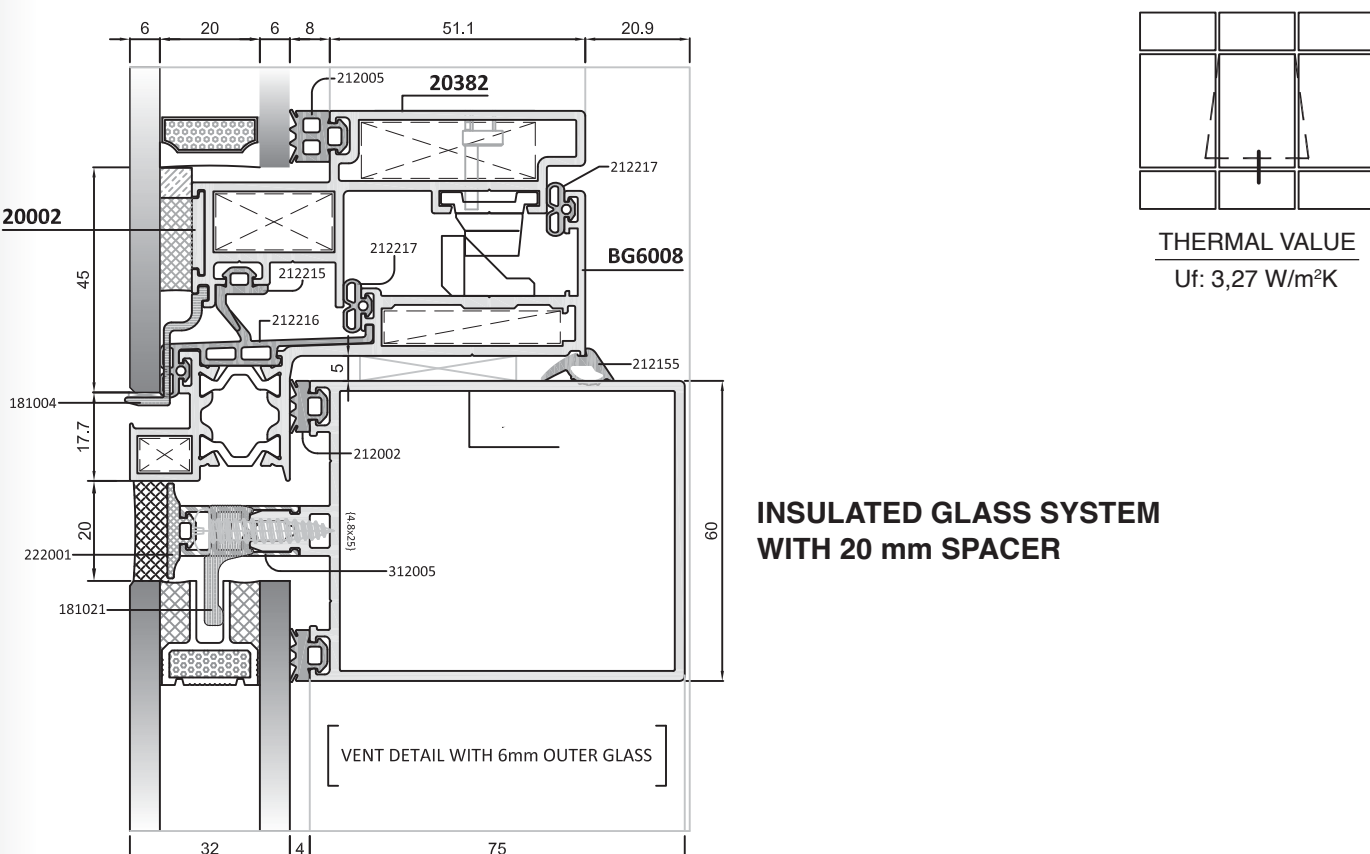

INSULATED GLASS SYSTEM
WITH 20 mm SPACER

TEST REPORT PERFORMANCE VALUES



Test Sample Dimensions

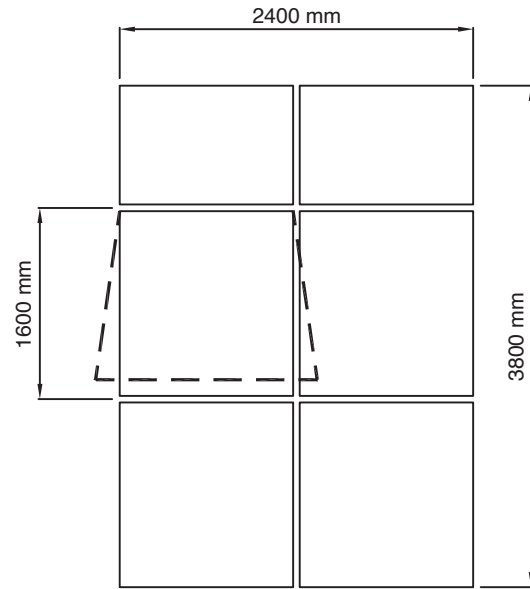

Capped Curtain Wall
Width: 2400 mm
Height: 3800 mm

*Resistance to wind load value of 900 Pa is according to the usage of the mullion depth as 80mm. The reason of this mullion selection is to see the watertightness of the system clearly even under the most difficult conditions.

TEST REPORT RESULTS

AIR PERMEABILITY - EN 12152	AO (0 Pa)	A1 (150 Pa)	A2 (300 Pa)	A3 (450 Pa)	A4 (600 Pa)	
WATERTIGHTNESS - EN 12154	R4 (150 Pa)	R5 (300 Pa)	R6 (450 Pa)	R7 (600 Pa)	RE... (750+ Pa)	RE1500 (1500 Pa)
RESISTANCE TO WIND LOAD - EN 13116	900 Pa*					
ACOUSTIC PERFORMANCE - EN 10140-2 EN 717-1	Rw (C; Ctr) = <u>32,6</u> (-1,6; -3,8) dB					
STATIC TORSION - EN 13115	Class 4 (350 N)					

** For further information, please ask for the test reports.