

MAESTRO 120 SLIDING

MAESTRO 120 is a new generation sliding system offering two and three rail standard sliding and lift-and-slide variations, with a depth of 120mm, providing thermal insulation.

INNOVATIVE DESIGN

Sliding systems, especially those used in areas where a wide field of vision is desired, are products that are preferred for their aesthetics. The curved design language used in MAESTRO 120 highlights the aesthetic and modern structure of the system. This curved structure, which can be seen in every detail of the system, is combined with thin sections used in parts such as joints that could disrupt visual integrity, creating a seamless integration with the structure. While the increase in aesthetics in architectural aluminum systems implies manufacturing and usage difficulties, such difficulties have not been compromised in the design and manufacturing characteristics of MAESTRO 120, as these challenges are planned at the very beginning of the design process.

ECONOMY

In MAESTRO 120, thin wall thicknesses are preferred that do not compromise surface quality and manufacturing characteristics, while geometric design features are used in parts that are important for load-bearing, providing both lightness and rigidity together.

EASE OF MANUFACTURING

Since all accessories of the system are designed to be used in common and to work in harmony with each other, MAESTRO 120 is unique in terms of ease of manufacturing.

ENERGY SAVINGS

Given the increasing importance of environmental awareness and energy savings, importance has also been given to thermal insulation features in MAESTRO 120.

SCALABILITY

MAESTRO 120 is designed with a system concept that can be easily expanded. This allows newly added solutions to be quickly adapted to the system.

USAGE LIMITS DIAGRAMS ACCORDING TO THE WIND LOAD

The curves in the table; drew according to the inertia value of the clamp profiles and the wind loads of 60, 96, 132 kg/m². The hatched area below the curves according to the selected wind load mean "applicable" dimensions. (Deflection Criteria): L / 300

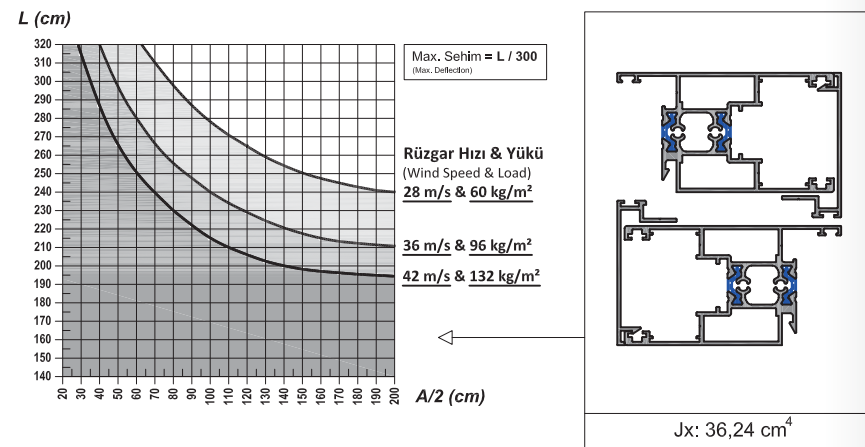
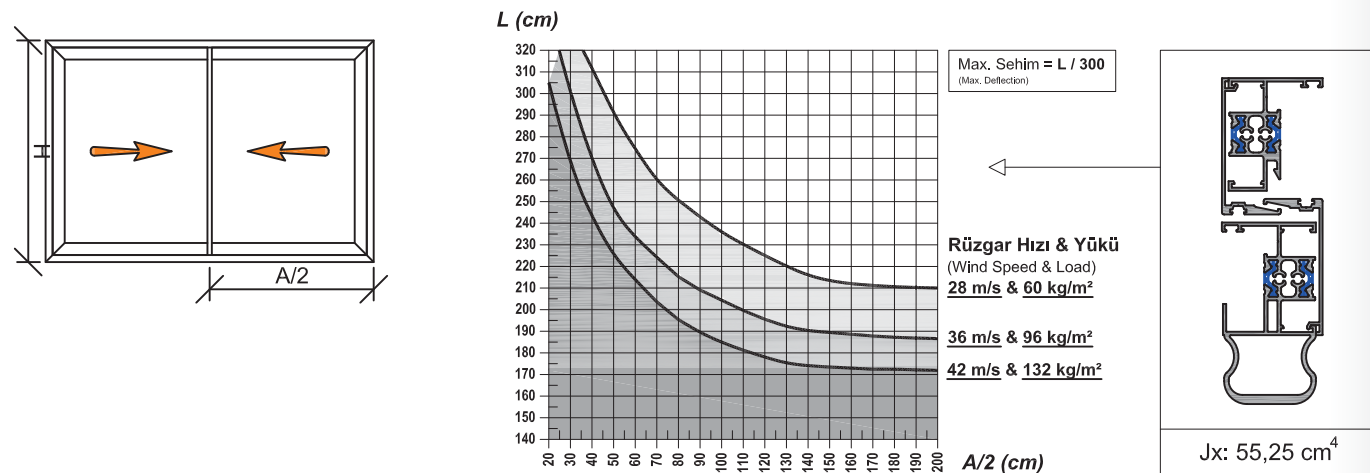

FERMOSA SYSTEM



www.burak.com.tr

Burak Alüminyum San. Tic. A.Ş.

Yeni Mah. 15th St. No: 3, TR-39780
Büyükkarşıran / Lüleburgaz / Turkey

@burakaluminum

/burak.aluminum

/burakaluminum

Phone : + 90 212 444 37 40

E-mail : info@burak.com.tr

in every aspect of life

FERMOSA SYSTEM

ARCHITECTURAL SYSTEM
BROCHURE

MAESTRO 120

insulated sliding



ECONOMICAL PERFORMANCE SLIDING DOOR SYSTEM

TECHNICAL PROPERTIES

Frame Depth:	120mm 170mm mm
Vent Depth:	49 mm
Profile Wall Thickness:	1,4 mm- 1,6 mm
Max. Glass Thickness:	36 mm
Insulation Bars:	16 mm
(Uf)-EN1077-2 / Thermal Insulation Value (Uf):	(Uf): < 2,48 W/m²K

APPLICATION ALTERNATIVES

Sliding (Lift Slides):	•	•
Monorail Frame:	•	•
Duople Frame:	•	•
Three Railed Frame:	•	•
Insect Screen Frame:	•	•
Self-Insect Screen Frame:	•	•

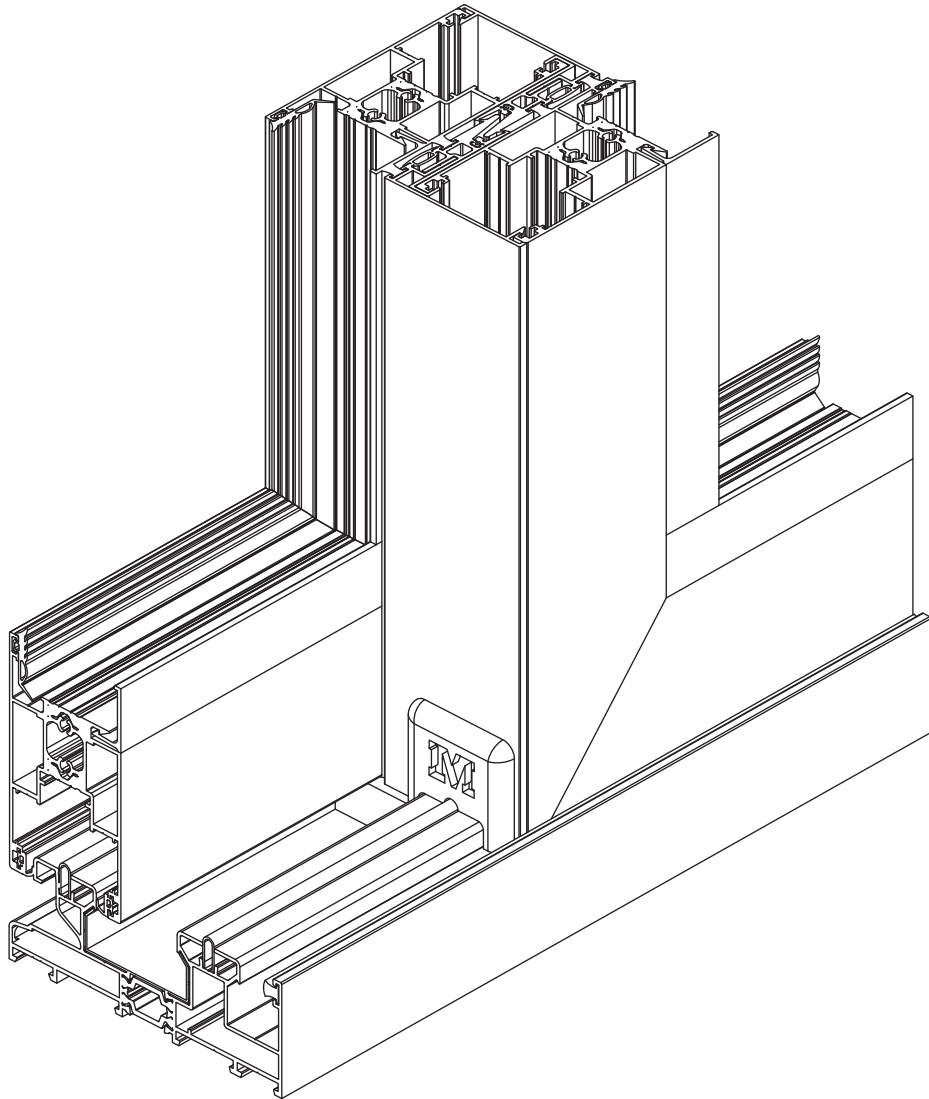

MAESTRO 120 SLIDING

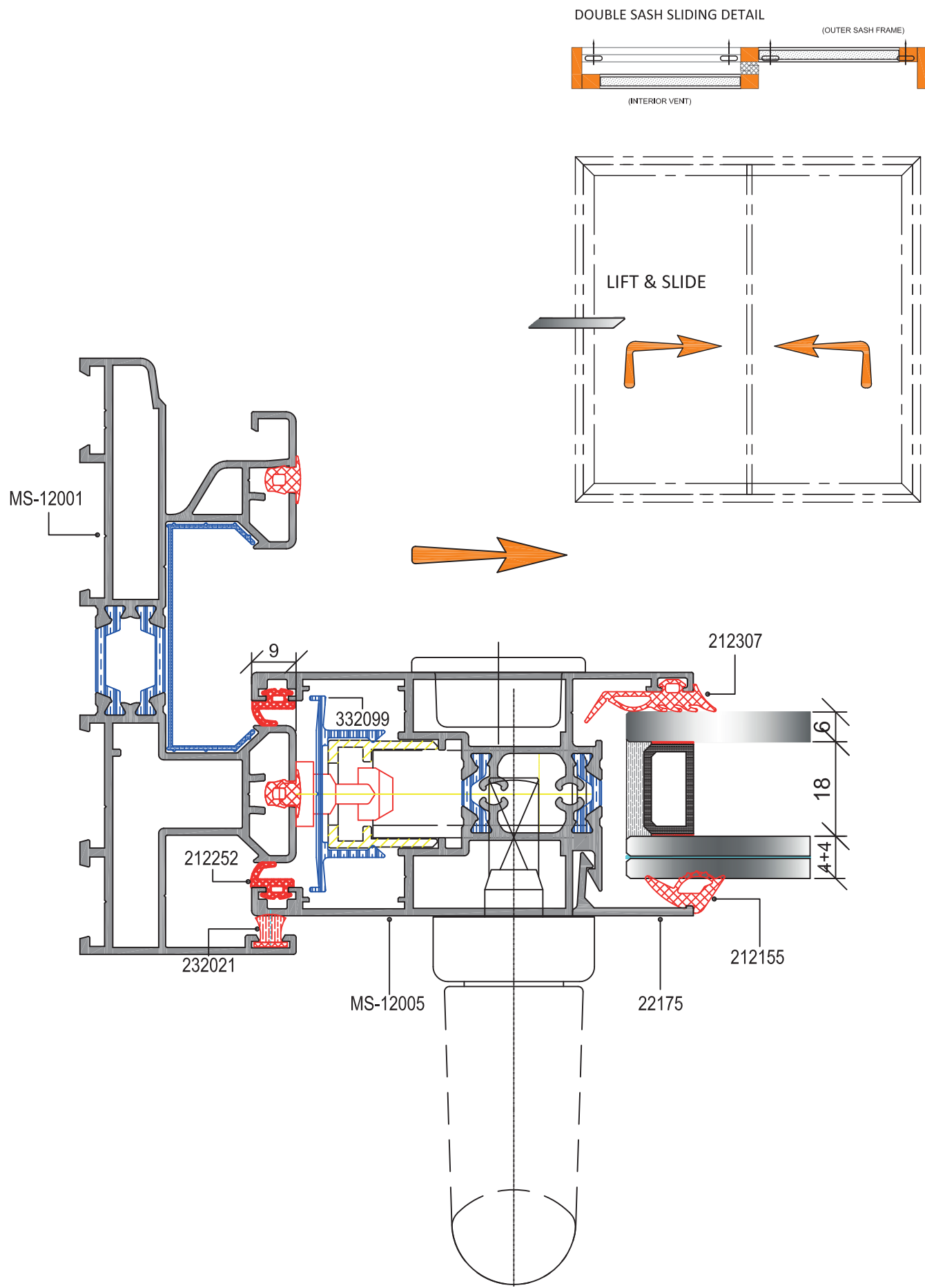

MAESTRO120 SLIDING

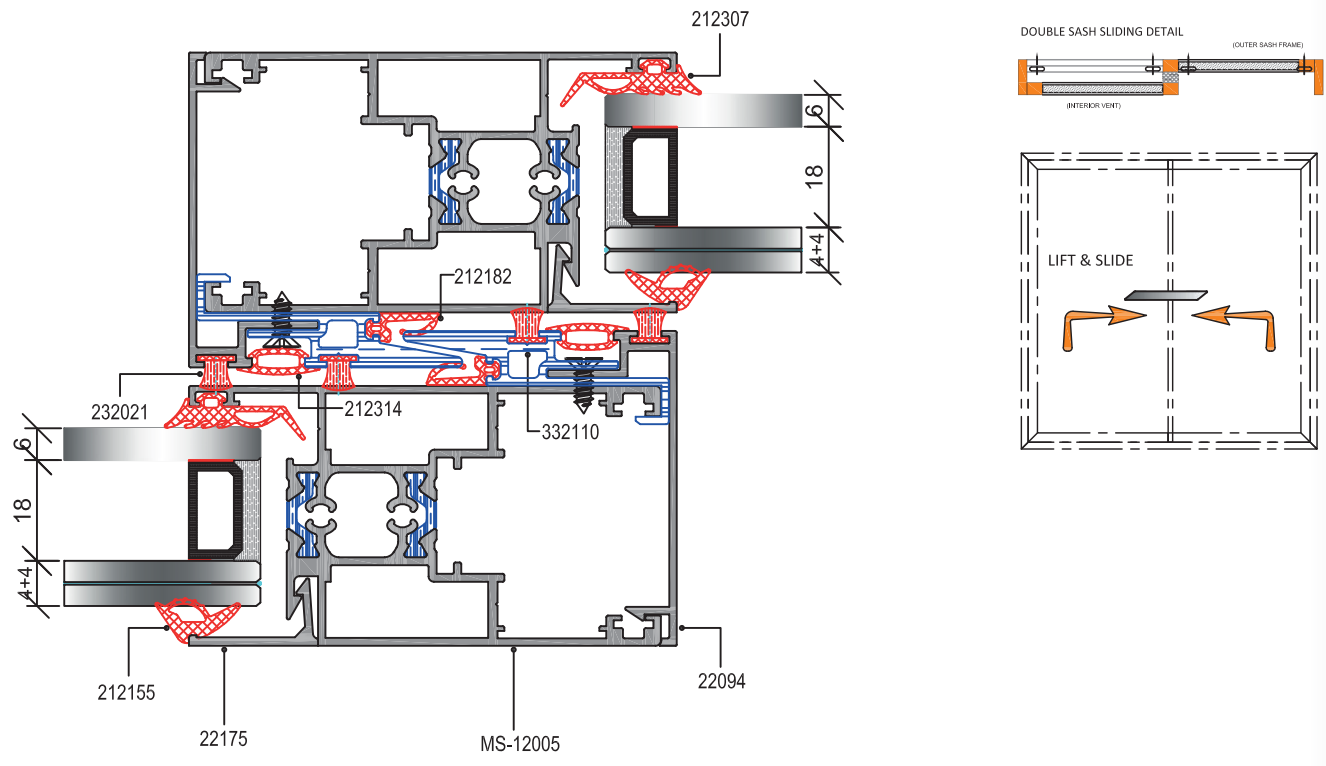

MAESTRO 120 SLIDING

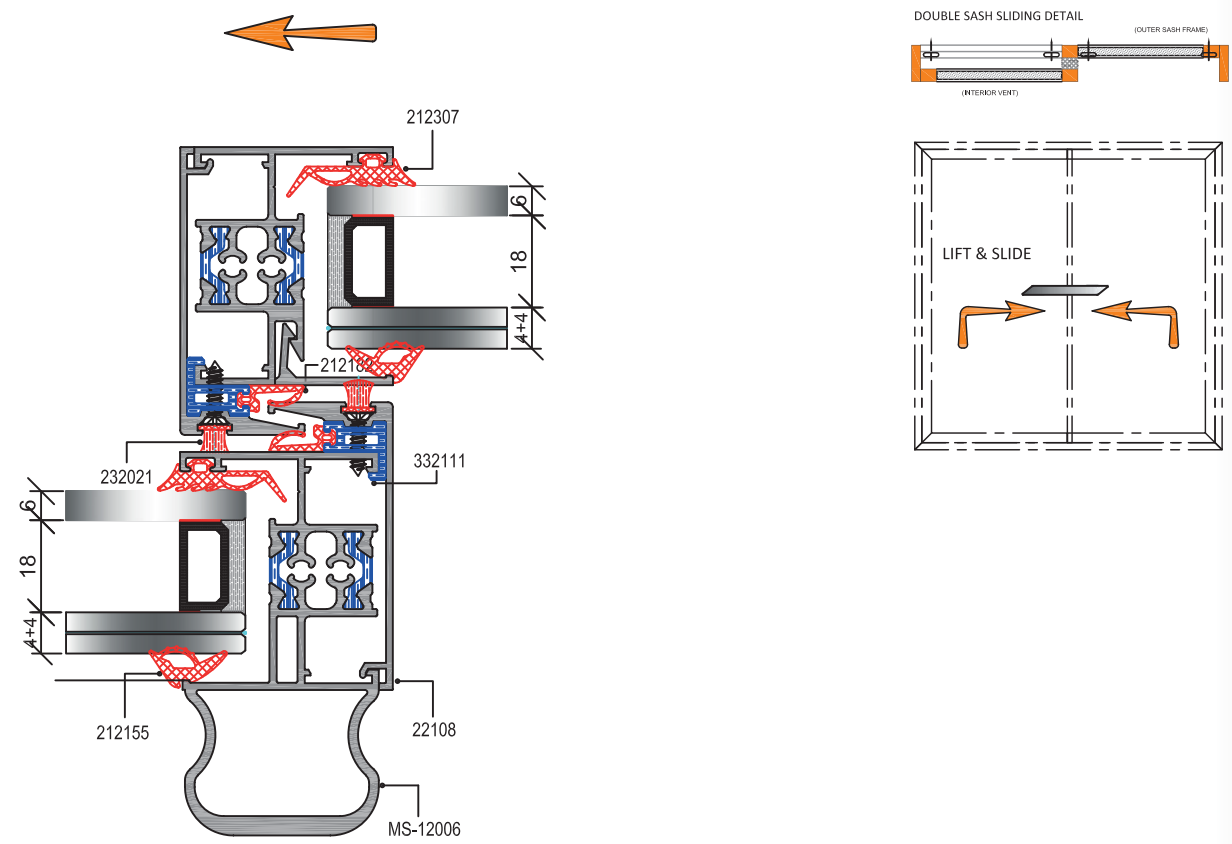

MAESTRO 120 SLIDING

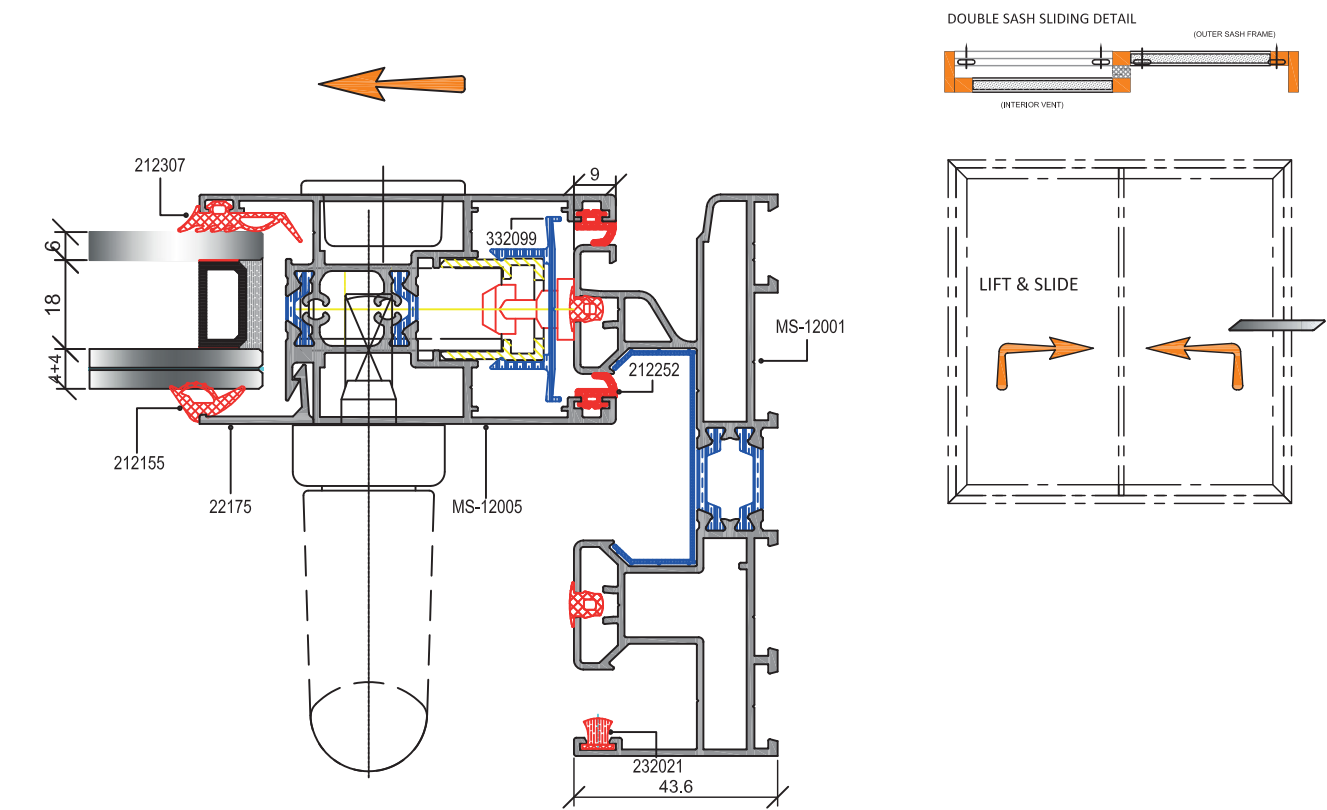

MAESTRO 120 SLIDING

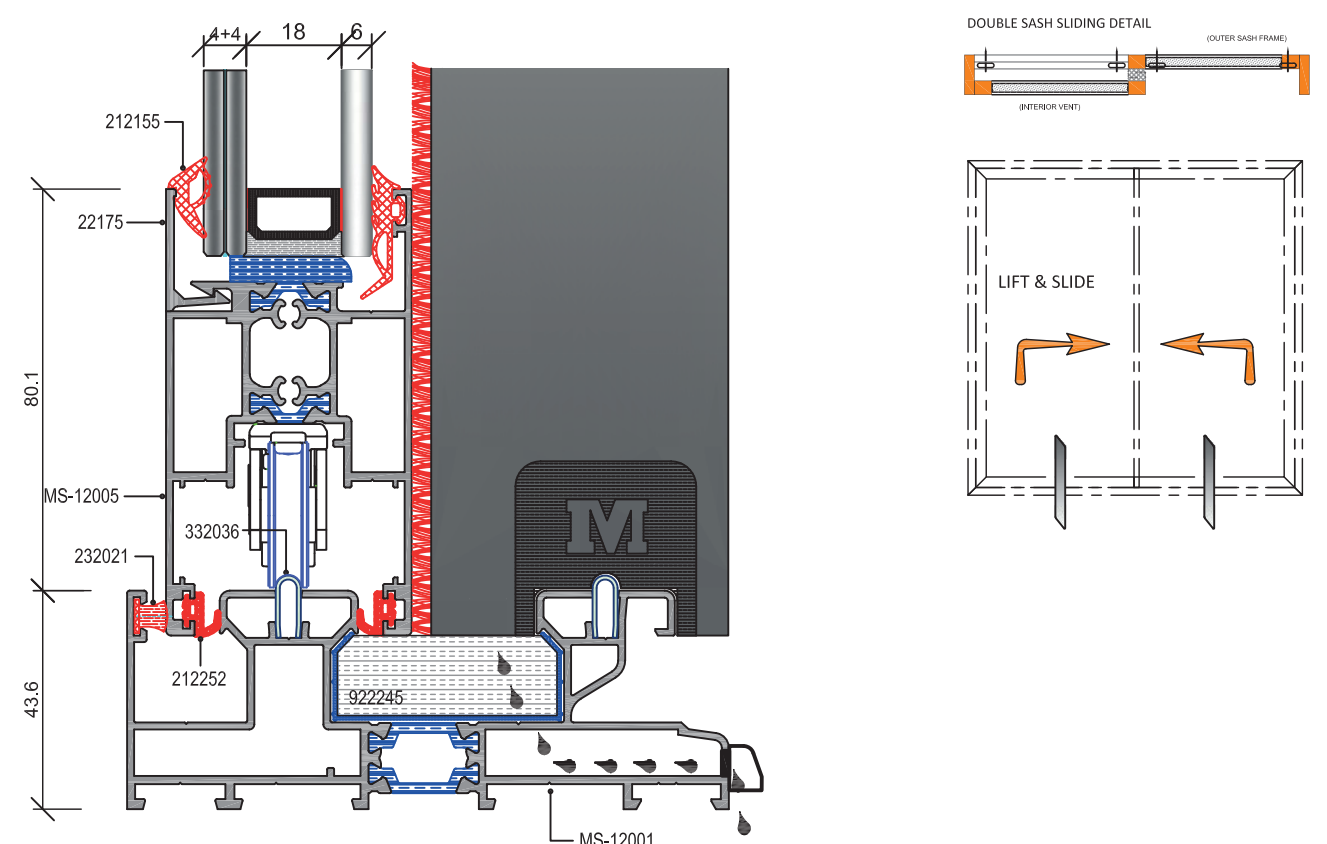

MAESTRO 120 SLIDING

