

## REFERENCES

Kuwait City Project / KUWAIT



Özgün Gıda Konutları / TRABZON



ARP Kule / ANKARA



SMK Tower / ANKARA



Laleh Project Tehran / IRAN



Kadıköy 1071 / ISTANBUL



Gence İdman Sarayı / AZERBAIJAN



State Hospital / SINOP



Dört Mevsim Çayyolu Project / ANKARA



Ankara 1071 / ANKARA



**burak**  
alüminyum



**Istanbul Office**  
Burak Plaza  
İstoç Oto Ticaret Merkezi  
2. Cadde A2 Blok  
No:1 Kat:13  
Bağcılar / İstanbul / Türkiye

**Factory**  
Yeni Mahalle 15. Sokak No:3  
Lüleburgaz / Kırklareli / Türkiye  
Phone: +90 444 37 40  
Phone: +90 (288) 436 12 34  
Fax: +90 (288) 436 13 63  
Email: info@burak.com.tr

Scan Code for Catalogue



@burakaluminum

/burak.aluminyum

/burakaluminum

www.burak.com.tr

## ARCHITECTURAL SYSTEMS

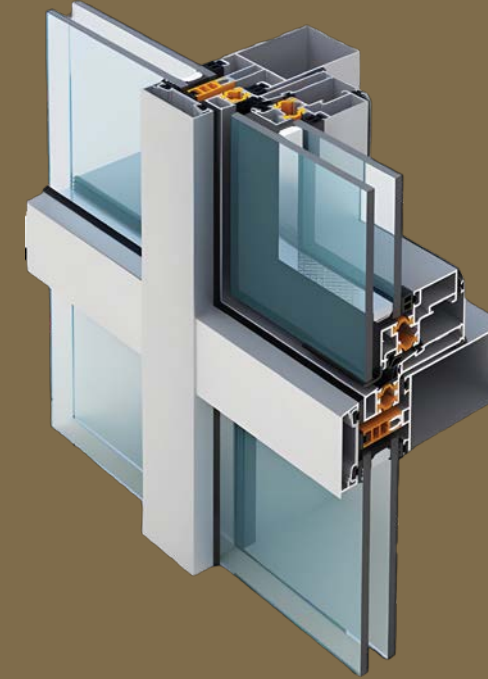

**BG50**

High Insulated  
Curtain Wall System

• **System Brochure**  
**Technical Properties**  
**System Details**  
**References**

**burak**  
alüminyum

**burak**  
alüminyum



### History

It founded its first extrusion line in 1991 to produce aluminium profiles. In 1995, electrostatic powder coating unit and foundry was opened. Burak implemented its first export in 1996. And the second extrusion line was commissioned in 1997. Extrusion lines were revised, and the foundry's capacity was increased in 1998. Developing of architectural aluminium building systems was commenced in 2002. 1,400 and 2,000 tons of extrusion lines, anodization unit CNC mechanical processing machinery were commissioned, and the 1st phase construction of 12,500 sqm Luleburgaz plant was completed between 2003 and 2008. The foundation of Luleburgaz plant was completed in 2011. Aksan Aluminium; that is the first extrusion company joined the group in 2012. In 2013, total 85,000 sqm Luleburgaz plant with 65,000 sqm indoor space was completed and set into operation with 6 extrusion lines.

### Product

**Burak Alüminyum Industrial:**  
Burak Alüminyum also performs special alloy aluminium profile manufacture besides standard alloy extrusion profile. Besides serving industries such as automotive, aviation industry, heating-cooling, furniture promotions and rail systems which need qualified design from A to Z, it manufactures solar energy, semi-finished and finished products composed of aluminium such as caravan, automotive, industrial fridges, and radiators.

**Burak Alüminyum Architectural Systems:**  
Burak develops architectural solutions. Manufacturing facade, doors and windows, sliding, office partition systems, handrail profiles and their compatible accessories, Burak also manufactures aluminium composite panels via its **BURAKBOND®** and **alu-linebond®** brands and exports these products more than 70 countries.





PRODUCT CONCEPT

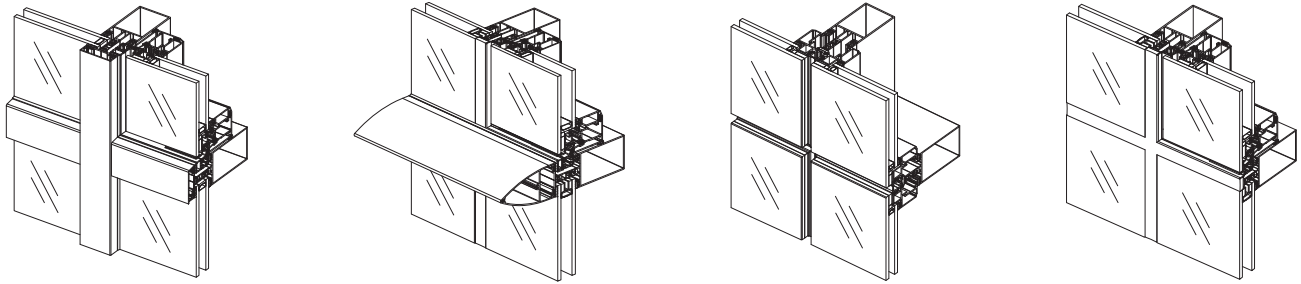

BG 50 "Burak Giydirme 50mm" is new generation curtain wall system that combines capped curtain wall, two sided, four sided and structural cells in a single system.

**ENERGY SAVING**  
Subjects of environment sensitivity and energy saving become important day by day. For this reason thermal insulation specifications was become on high level. In spite of Aluminium is a cold material in accordance with its structure, it can be as insulative composite structure by variability of materials, design methods and technologies.

BG 50 was designed exactly performance-focused as requirements of present day. Important sides of BG 50 are high performances of thermal and air-water tightness, variously usage options, easy manufacturing specifications.

**INNOVATIVE DESIGN**  
Structure is look like conventional with vertical corner and thick lines in design. Conversely the corners with huge radius preferred with thin profile sections, curly surface and pitched edges. But ease of use and manufacturing specifications did not abandoned.

**EASE OF MANUFACTURING**  
Accessories of BG 50 was mostly standardized. These accessories used generally common with each other. By this method, different types of products is manufactured with the same accessories.

**IMPROVABILITY**  
BG 50 has the developable system concept as general. In this way adaptation of new system solutions can be done quickly.

HIGH THERMAL INSULATED CURTAIN WALL SYSTEM

TECHNICAL PROPERTIES

Profile Widths:	50 mm
Mullion Depths:	50, 80, 100, 120, 140, 160, 180, 200, 220
Transom Depths:	55, 85, 105, 125, 145, 165, 185, 205, 225
Profile Wall Thickness:	1,6 mm - 2,8 mm
Max. Glass Thickness:	42 mm
Insulation Bars:	10 mm - 30 mm
Thermal Insulation Value (Uf):	1,47 W/m²K - 3,85 W/m²K

APPLICATION ALTERNATIVES

Capped Curtain Wall:	•
Curtain Wall With Structural Cells:	•
Four Sided Silicone Curtain Wall:	•
Two Sided Curtain Wall:	•
Top Hung Outward Opening Hidden Vent:	•
Parallel Outward Opening Hidden Vent:	•
Steel Reinforced Curtain Wall:	•

HIGH PERFORMANCE CURTAIN WALL SYSTEM

Profile Depth: 50 mm  
Profile Wall Thicknesses: 1,6 mm - 2,8 mm  
Mullion Depths: 50, 80, 100, 120, 140, 160, 180, 200, 220 mm  
Transom Depths: 55, 85, 105, 125, 145, 165, 185, 205, 225 mm  
Maximum Glass Thickness: 42 mm  
Insulation Bars: 14 mm - 30 mm  
Thermal Insulation Value (Uf): 1,47 W/m²K  
Application Alternatives: Capped, Fourside, Twoside, Structural Cells.  
Opening Vent Alternatives: Top Hung, Parallel.

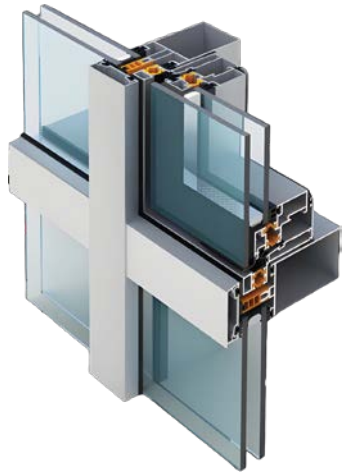

BG50  
PRODUCT  
INFORMATION

CURTAIN WALL HORIZONTAL DETAIL

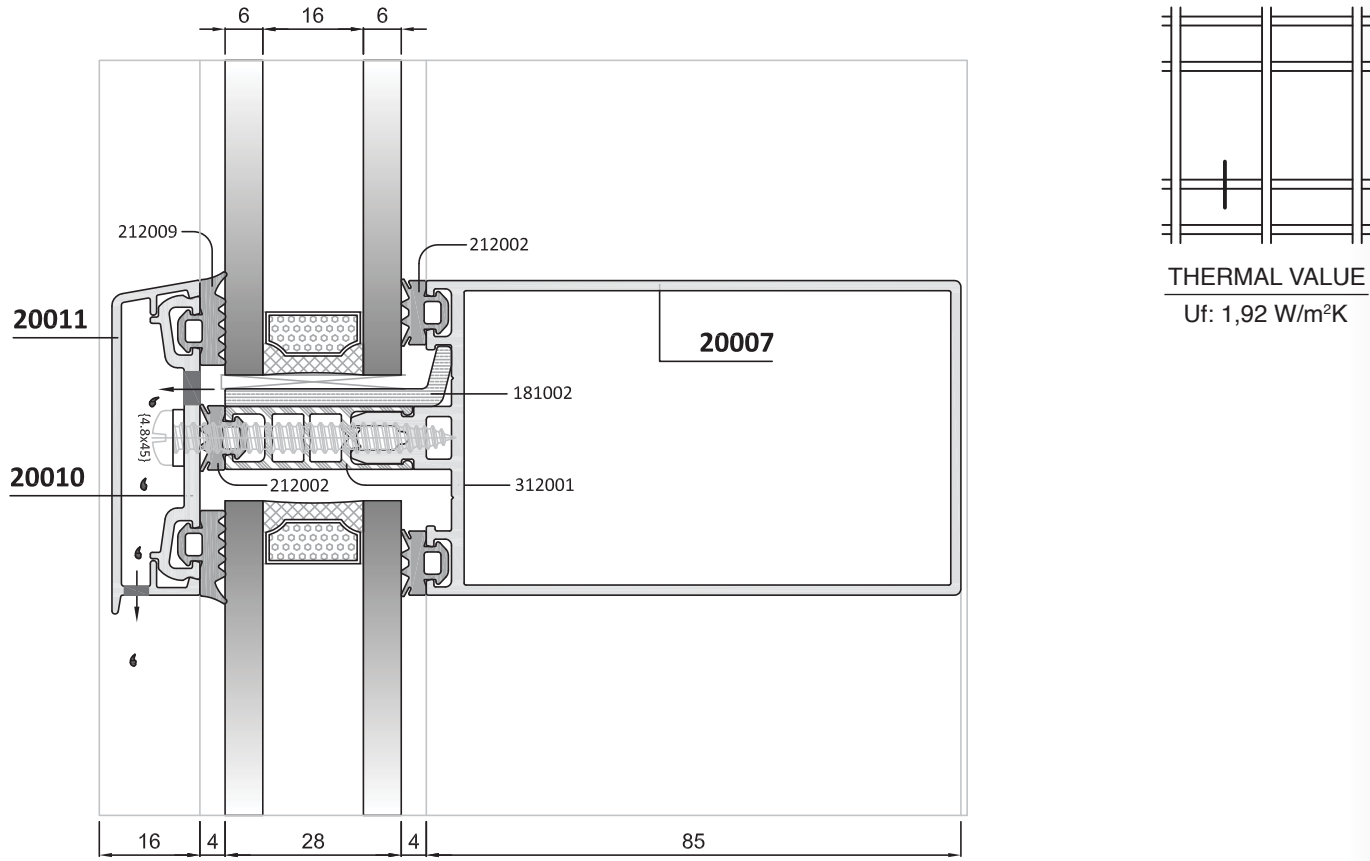

TOP HUNG OUTWARD OPENING DETAIL IN THE CURTAIN WALL

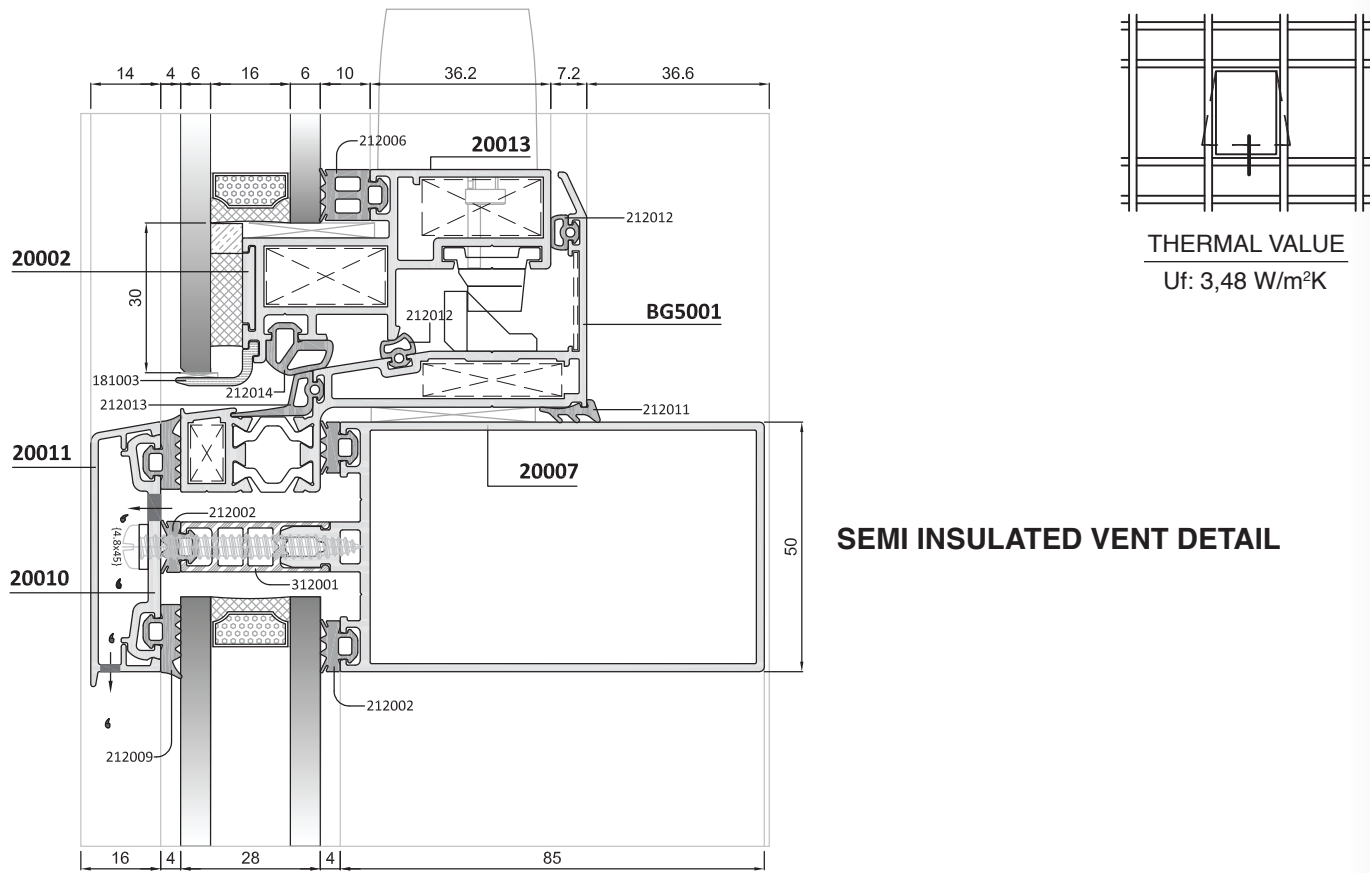

FOUR SIDE HORIZONTAL DETAIL

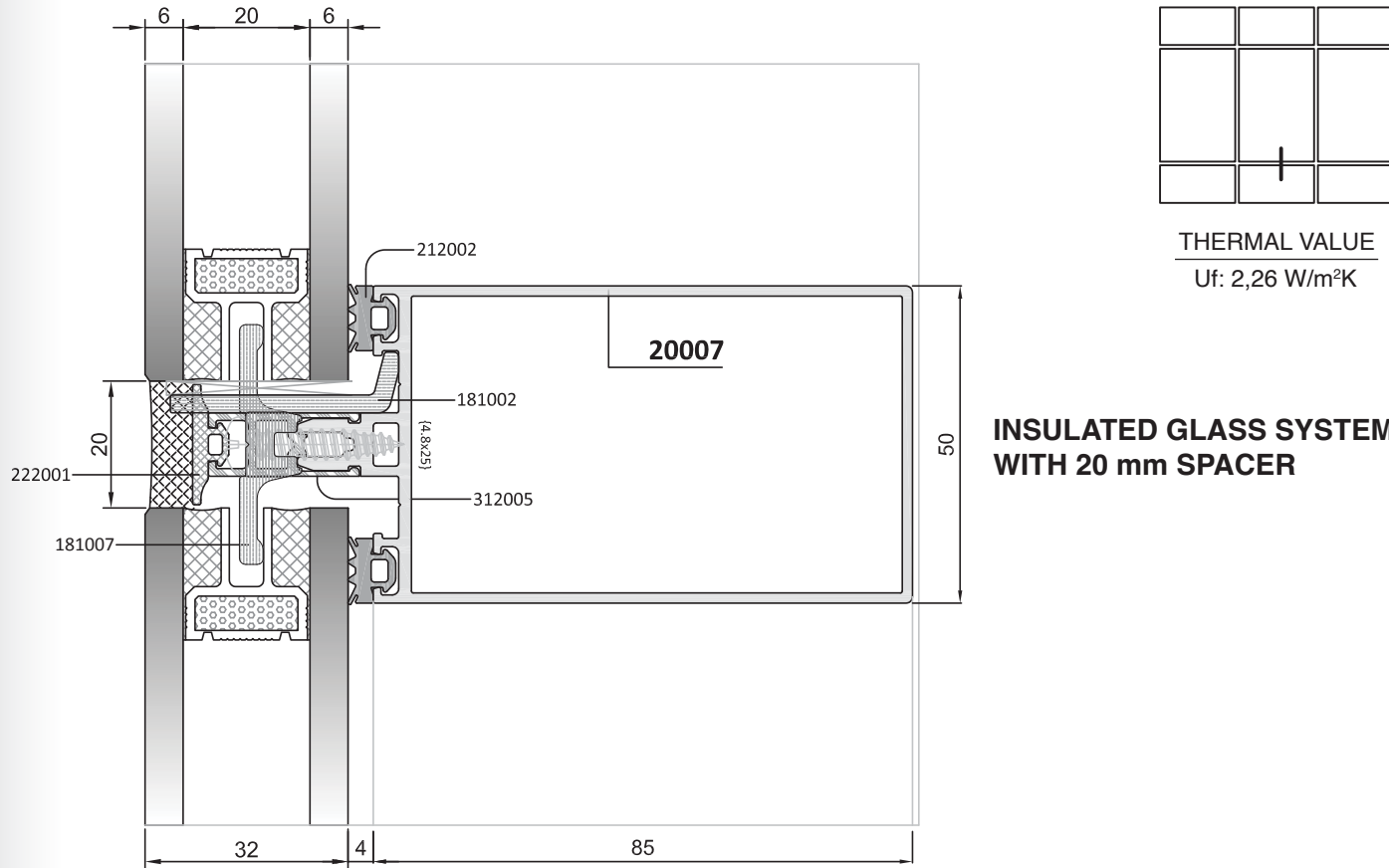

TOP HUNG OUTWARD OPENING DETAIL IN FOUR SIDE

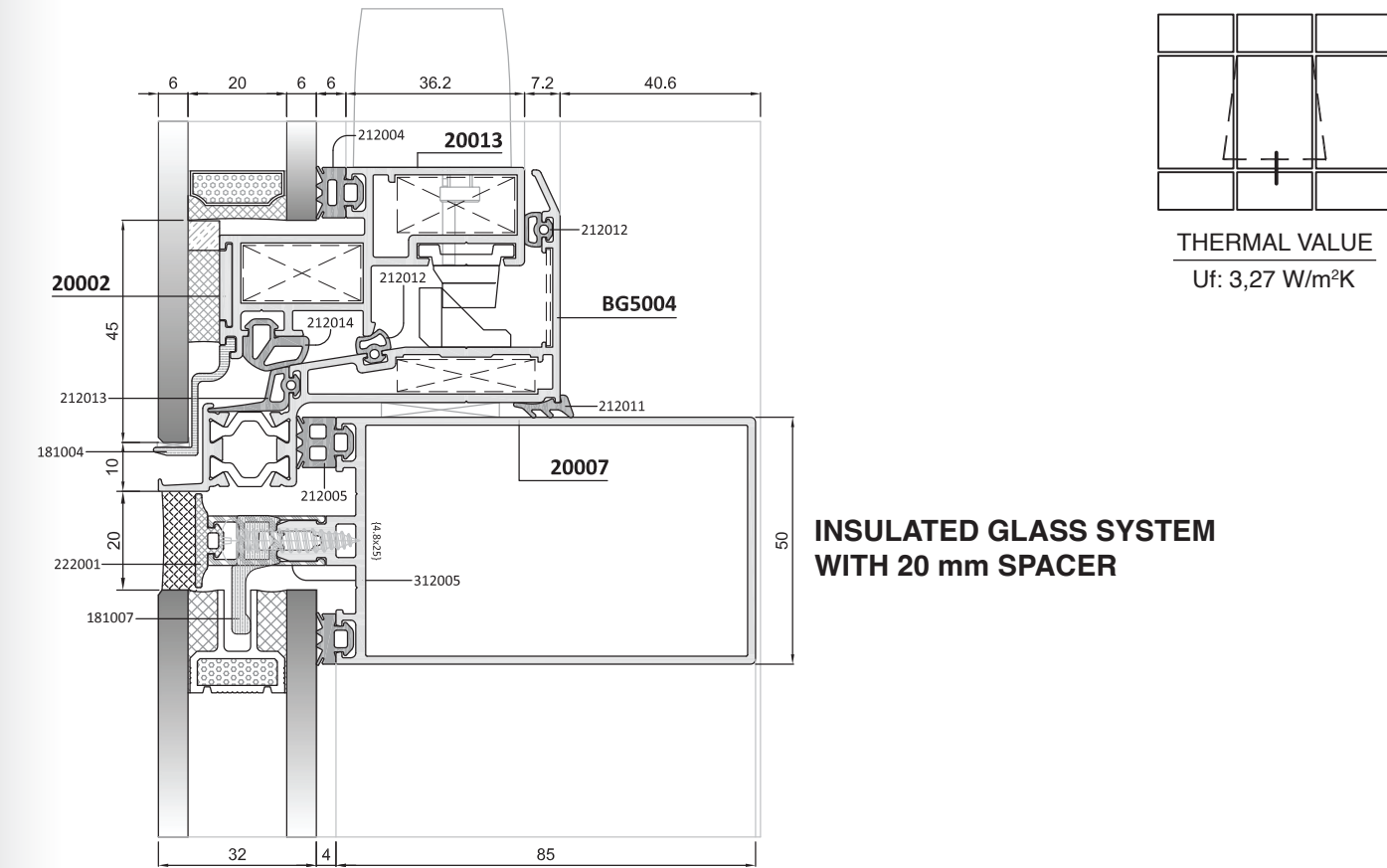

TEST REPORT PERFORMANCE VALUES

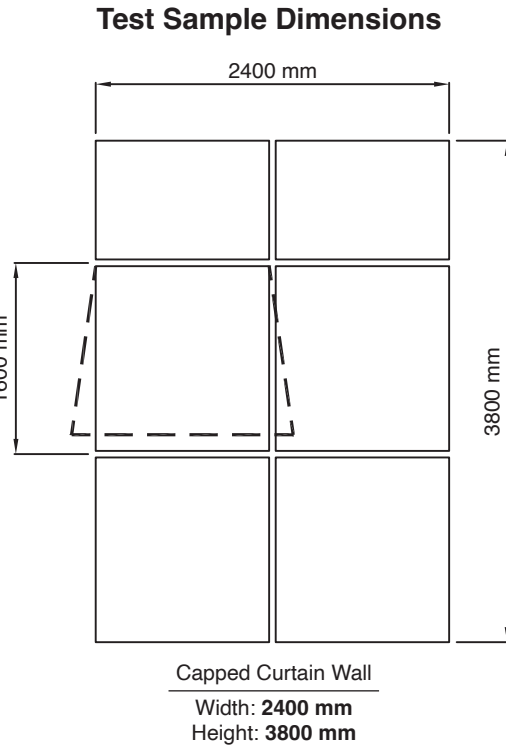

\*Resistance to wind load value of 900 Pa is according to the usage of the mullion depth as 80mm. The reason of this mullion selection is to see the watertightness of the system clearly even under the most difficult conditions.

TEST REPORT RESULTS

AIR PERMEABILITY - EN 12152	AO (0 Pa)	A1 (150 Pa)	A2 (300 Pa)	A3 (450 Pa)	A4 (600 Pa)	
WATERTIGHTNESS - EN 12154	R4 (150 Pa)	R5 (300 Pa)	R6 (450 Pa)	R7 (600 Pa)	RE... (750+ Pa)	RE1500 (1500 Pa)
RESISTANCE TO WIND LOAD - EN 13116	900 Pa*					
ACOUSTIC PERFORMANCE - EN 10140-2 EN 717-1	Rw (C; Ctr) = <b>32,6</b> (-1,6; -3,8) dB					
STATIC TORSION - EN 13115	<b><u>Class 4 (350 N)</u></b>					

\*\* For further information, please ask for the test reports.